SMART BIO-ETHANOL ELECTRONIC BURNER



Tilt automatic flameout device

Combustion control device

Safe ignition device

CO₂ monitoring device

Overheating prevention device

Overflow prevention device

User's Manual

What's in the box:

Smart Burner-----	1pc
Remote Control -----	1pc
AC Adapter -----	1pc
Filling Hose -----	1pc
Siphon Hose-----	1pc
Lift Up Handle-----	1pair
User's Manual -----	1pc



AC Adaptor



Plug



Remote Control



Filling Hose



Air Rub Ball
(Use it only for empty
fuel tank inside of burner)



Lift Up Handle

Instruction Index

1, Connect & Install -----	Page 3
2, Required Reading Before Use -----	Page 4
3, Fuel Information -----	Page 5
4, Automatic Fill -----	Page 5
5, Manual Fill -----	Page 6
6, Minimum Fuel Capacity -----	Page 6
7, Remote Control Battery -----	Page 7
8, Flame Size Adjustment -----	Page 7
9, Extinguishing Flame -----	Page 7
10, Linked Group Connection -----	Page 8
11, Child Lock -----	Page 8
12, Fine Adjustment on Fuel Consumption Setting -----	Page 9
13, Adjusting combustion tray to horizontality -----	Page 11
14, Cleaning -----	Page 11
15, Siphon Fuel Out of Burner -----	Page 12
16, Warnings -----	Page 13
17, Data Sheet -----	Page 14
18, Trouble Shooting -----	Page 15
19, Warranty -----	Page 16

1, Connect & Install

- Be sure to remove all packing materials, cardboard, white cloth-like material in burner etc.
- The fireplace is intended to be placed on a floor or sturdy surface.
- Choose a location 4 feet away from flammable objects or materials(drapes, fabrics, furniture, etc.).
- Plug in the Smart Ethanol Burner by connecting the adapter to both the burner (socket located on the burner's right side as you are facing it) and an electrical outlet, please connect the smart home system connection as well if this function is available.

Remark: For 18" (45cm)size burner, the electricity connector is located on left side of burner

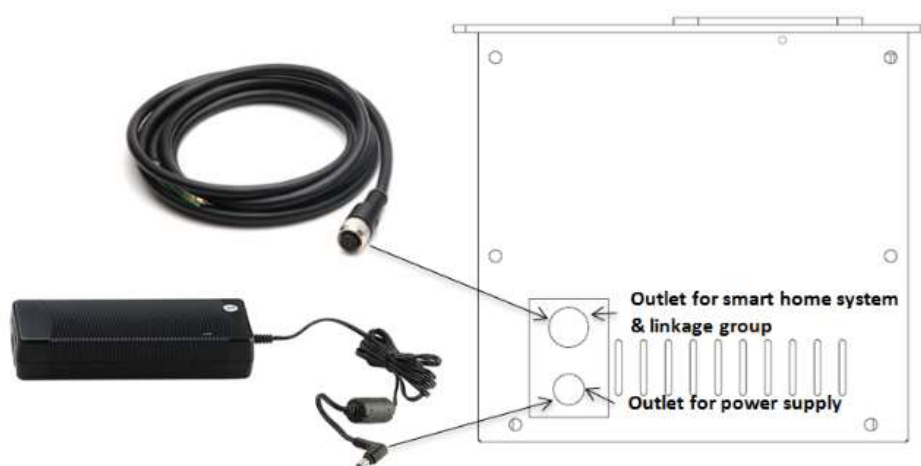

- Install the burner into the non-combustible surround that you've specified for installation. **This burner is designed for indoor use only, if you want to use it outdoor, please keep it away from wet(rain/water) environment or ask distributor for outdoor solution.**
- Use the two handles to lift burner up then fit into existing fireplace surround. Please make sure to remove the handles before starting the device and keep them for the lifetime of the product incase need it for remove the device in future.

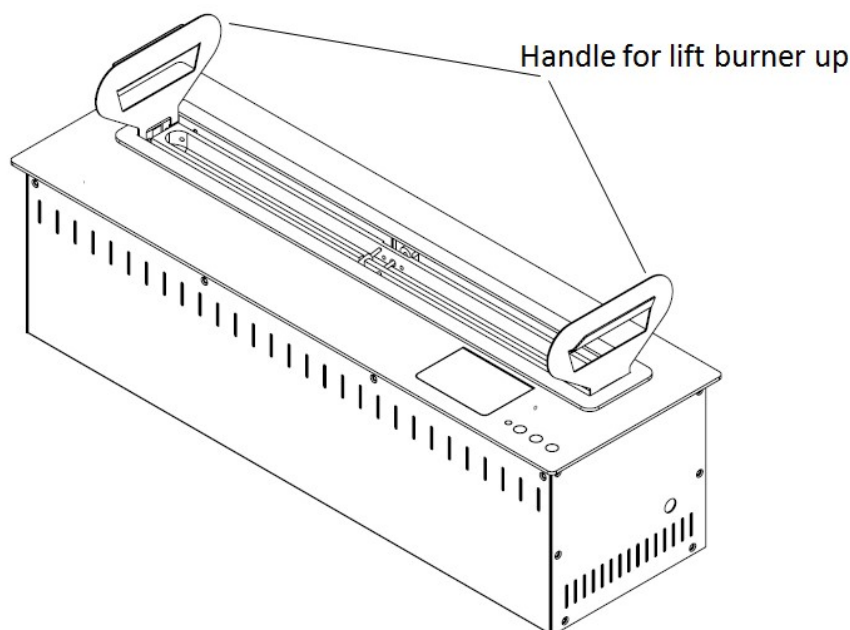

- The Smart Ethanol Burner can be fitted into a firebox that has minimum clearances as outlined below.
- Custom made fireboxes must be made out of a non-combustible material such as stainless steel, stone, wonder board. Please leave a electricity power connection socket on the right side under/near the hole for burner fit in. And please have this socket electricity supply can control on/off from outside wall.

Front Clearance (A)	Rear Clearance (B)	Side Clearance (C)	Overhead Clearance(D)	Nearest combustible Radius
4 inch 10cm	4 inch 10cm	4 inch 10cm	24 inch 61cm	24 inch 61cm

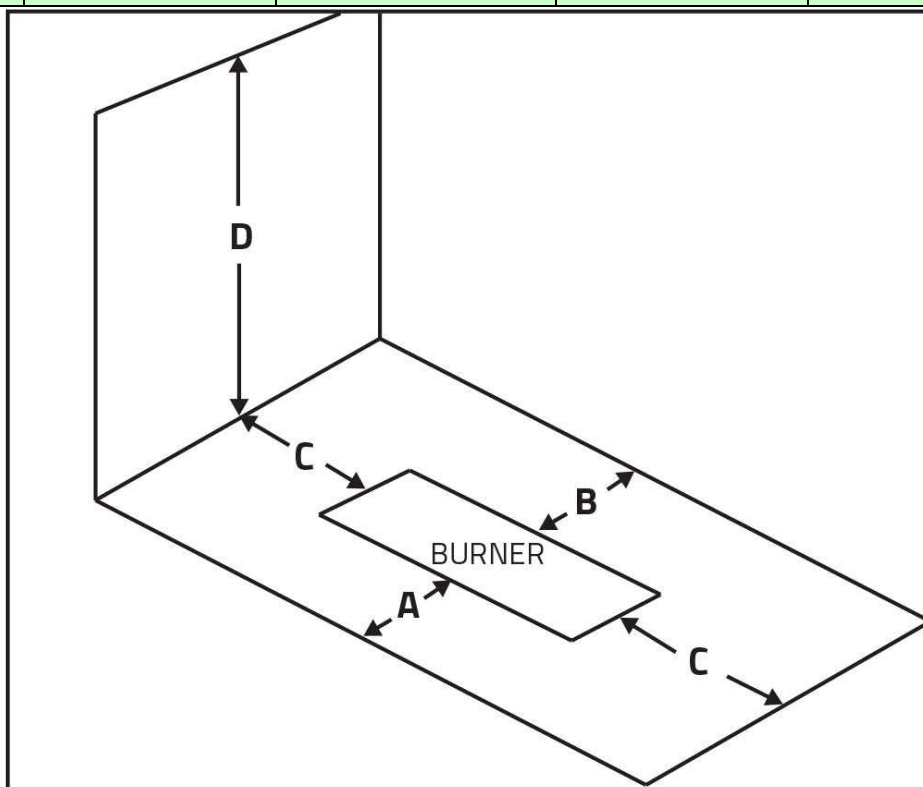

2, Required Reading Before Use

IMPORTANT!!!

- *Before filling your burner, it is important that you follow the step-by-step instructions that follow on the next two pages.*

DO NOT PRESS THE POWER BUTTON MORE THAN INSTRUCTED.

- *When you press the power button once, it only initiates the burner itself - not the flames.*
- *When you press the power button a second time (when instructed), it initiates the pilot and fuel flow.*

NEVER PRESS THE POWER BUTTON A THIRD TIME.

- *During the initial use, you will notice the pilot become red and fuel begin to drip into the*

combustion tray. Fuel will continue to flow for approximately two (2) minutes, as the pumps are being primed. During this time, DO NOT PRESS THE POWER BUTTON.

• *Please Note: This burner is equipped with a ten (10) minute safety feature, indicated by the power & both arrow buttons flashing for 1 minute and non-response until temperature reach safe data. Once the burner is powered off, you must wait ten (10) minutes prior to using again.*

Warning: Never refill the burner when the fireplace is operating or still hot.

Never pour fuel into a burning flame.

Allow the burner to cool down for at least 30 minutes before refilling.

3, Fuel Information

• USE ONLY APPROVED BIO-ETHANOL LIQUID FUEL (95% up purity) FOR INDOOR FIREPLACES.

Bio-Ethanol Liquid Fuel for fireplaces burns clean without emitting any toxins into the air. Only harmless water vapor and CO₂ are produced as byproducts.

4, Automatic Fill



- Make sure the burner is electricity connected.
- Be sure burner is leveled before processing.
- Press the fuel door located on the front right-hand side as you face the burner.
- Insert one end of the fuel hose into the fuel tank nipple.
- Insert the opposite end into the bottle of liquid ethanol fireplace fuel.
- Press button illuminated in blue, located to the right of the nipple.
- Continue filling until process automatically stops.
- If just want to fill a little fuel to have a try on this device, please in accordance to the burner's minimum trigger level(Refer to 6 Minimum fuel capacity).
- Carefully remove the hose from both the nipple and the bottle, cleanup any fuel that has spilled.
- Close the fuel door.
- Press power button TWICE within 10 seconds to ignite burner.

5, Manual Fill

- Open the fuel door located on the right-hand side as you face the burner.
- Remove the gold-colored cap that is located on the far left.
- Insert a funnel in order to safely pour the liquid fuel into the fuel tank.
- Pour the fuel from the bottle into the funnel, please stop filling once the light of button which next to the filling hole is off. The blue lighting off indicates it reach the max fuel level. But please in accordance to the burner's minimum trigger level(Refer to 6 Minimum fuel capacity).
- Once you've filled the fuel tank to the desired level, shake the funnel before removing to ensure that excess fuel isn't spilled. Wipe up any fuel that may have dripped.
- Replace the gold cap on the fuel tank.
- Close the fuel door.
- Press power button TWICE within 10 seconds to ignite burner.

Note: If both green arrows is flashing along with 1 long and 1 short beep, this indicates that the fuel is not reach minimum trigger fuel level.

6, Minimum Fuel Capacity

18 inch - 1 Liter 24 inch - 2 Liters

30 inch - 3 Liters 36 inch - 4 Liters

48 inch - 5 Liters 60 inch - 6 Liters

72 inch - 7 Liters 84 inch 8 Liter

7, Remote Control Battery

- Open the removable panel on the back of the remote control.
- Place Lithium Cell CR2032 3V battery inside ensuring that the positive (+) is facing you.
- Ensure that the stainless steel ground is ON TOP of the battery.
- Close removable panel.

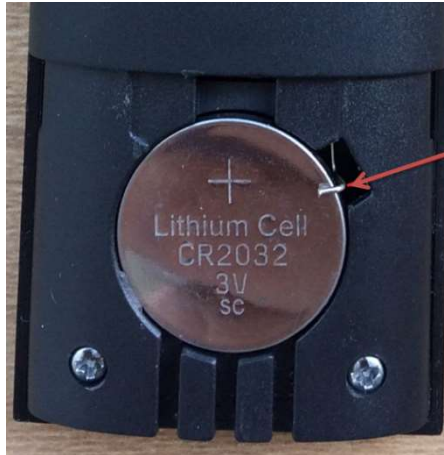

See illustration.

8, Flame Size Adjustment

Once the flame reaches the entire length of the combustion tray, you may adjust its intensity (flame length) at your discretion. Simply press the “UP” arrow on the burner casing or remote control device for a more intense flame; The “DOWN” arrow for a less intense flame. The Smart Burner Series is equipped with 6 adjustable heat settings: On, Flame size 1, Flame size 2, Flame size 3, Flame size 4, Off.

9, Extinguishing Flame

- To extinguish the flame, simply press the power button on the burner casing or remote control one time.
- Once power button has been pressed, the pump will cease introducing fuel into the combustion tray.
- As confirmation that the burner has been powered off, the green power button and arrows will be illuminated.
- The remaining fuel in the combustion tray will burn off. This may take a few minutes after powering the burner off.
- *Please Note: This burner is equipped with a ten (10) minute safety feature, indicated by the power & both arrow buttons flashing for 1 minute and non-response until temperature reach safe data. Once the burner is powered off, you must wait ten (10) minutes prior to using again.*

10, Linked Group Connection (Optional)

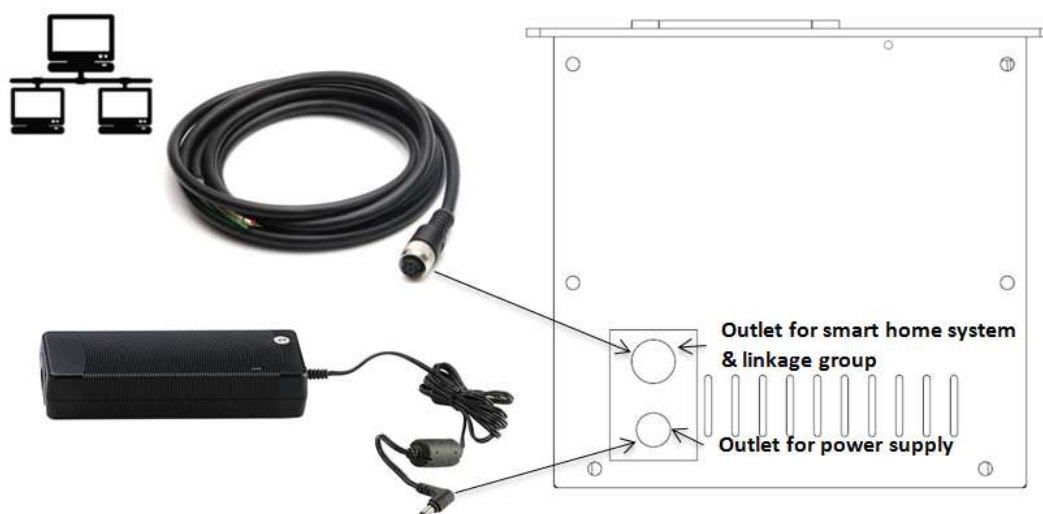

- Step 1: Please connect both burner with power supply.
- Step 2: Please connect burners with the cords provided. Then burners are linked together.
- There is remark on the left side panel indicated which burner is host-burner and which is sub-burner. Every Operation on host burner will be conducted to the sub-burner as well except fuel filling. The button on top panel of sub-burner is also valid, but it only control on itself.

11, Unlock Child Lock (Optional)



Child lock model is valid only when fireplace is off.

To unlock the Child lock model:

Option 1, Please press on the power button on burner panel for 3~9 seconds to unlock. Then press power button twice to turn on burner in next 30 seconds.



Option 2, Please click the home button twice on the remote control to unlock. Then click power button twice to turn on burner in next 30 seconds.



Remark:

- 1, Please note the Child lock model will be back to work without further operation in 30 seconds.
- 3, When the fireplace is on, the chold lock model is invalid.

12, Fine Adjustment on Fuel Consumption Setting

In case required to change the default setting of fuel consumption, fine adjustment is available by following below steps:

There will be beep sound if adjusting set successfully.

Please ensure operation on button should be done within 10 seconds.

Fine adjusting on 1st chamber:

Illustration:

When burner is working under largest flame size setting
One hand press the up arrow all the time



Another hand press the home button twice,
then press left (decrease flame) or right (increase flame) one time.

2nd, Press - or + one time

1st, Press home twice



Fine adjusting on 2nd chamber (Only applicable for burner with two chambers):

Illustration:

When burner is working under largest flame size setting
One hand press the up arrow all the time



Another hand press the manual button twice,
then press left (decrease flame) or right (increase flame) one time.

2nd, Press - or + one time

1st, Press manual twice



Resume to default setting:

Illustration:

When burner is working under largest flame size setting
One hand press the up arrow all the time



Another hand press the return button thrice

Press return thrice



13, Adjusting combustion tray to horizontality

If the flame only stay at one end in large flame setting after light on for more than 10 minutes, that's mean the combustion tray is not sit right in horizontally, please turn off the burner. After burner cool down, please use a screw driver to tighten(sink) or loosen(up) the screw in order to let this end of the chamber sink or up a little. See below illustration for reference.

NEVER DO THIS WHEN THE BURNER IS LIGHTING ON OR STILL HOT.

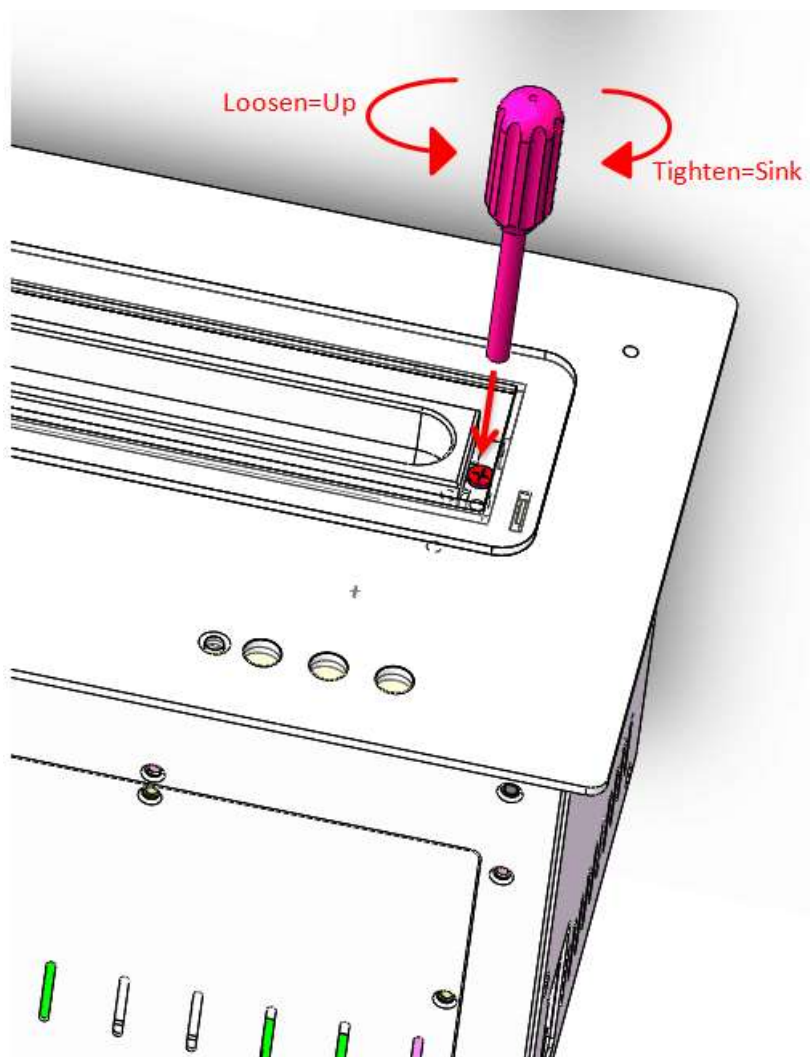

14, Cleaning

1. The burner surface must be cleaned regularly. Use warm water and soap.
2. Check the cover of burner for warping or damage before using.
3. Marks can be best removed with a soft cloth and a mixture of lukewarm water and a small amount of cleaning liquid (ph-neutral). We recommend cleaning the stainless steel items regularly to prevent contamination.

CAUTION: Never use chemical, steel-wool or scrubbing sponges to clean the fireplace. It can damage the surface.

The manufacturer cannot be held responsible for any damages resulting out of improper use and/or cleaning of the products.

15, Siphon Fuel Out of Burner

Please empty the fuel inside burner in occasion of store this burner or transport it to other place. Please use the siphon hose which with a black ball to siphon fuel out of the burner as per below instruction. Please keep this siphon hose lifetime of the burner in case need it in future.

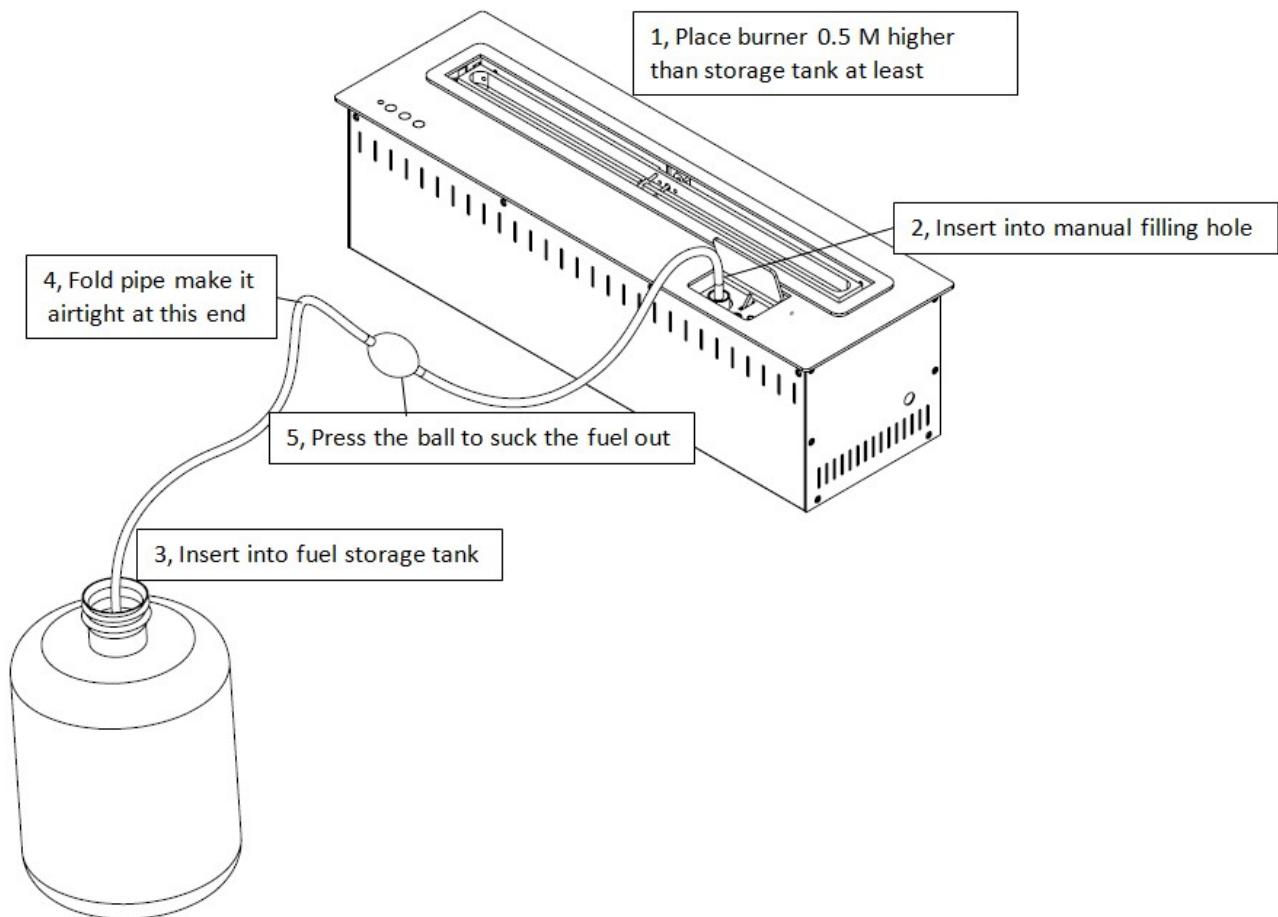

16, Warnings



1. Fireplace and burner get hot while in operation. Do not touch the fireplace while burning. Please allow at least 30 minutes to cool down before touching the product after flame is extinguished.
2. Risk of burns. Do not operate the ethanol fireplace without completed assembly.
3. Do not fill fuel into an open flame or into the burner reservoir unless it has cooled down for at least 30 minutes after use.
4. Do not place any flammable material within 1 meter/ 40 inches around the fireplace. A safety distance of at least 2 meters/80 inches should be kept from any window or curtain.
5. Do not burn under over hanging items.
6. Do not smoke while handling the fuel.
7. Protect fireplace against draft (fans high breeze). Never fan the burner. Do not position the fireplace near combustible items.
8. Risk of Explosion
 - i. Never use any fuel other than Bio Ethanol that is specifically intended for use with indoor vent less ethanol fireplaces. Never use gasoline.
 - ii. Never use the appliance in areas where flammable vapors or gas may be present.
 - iii. Never store or transport the fuel in other than a metal or plastic container that is acceptable for use with the specified fuel in accordance with the Consumer Chemicals and Containers Regulations 2001 and is the original container for the specified fuel.
 - iv. Never store fuel in the living space or in the same location as the appliance.
9. Do not use the appliance to heat or boil water or use as a cooking appliance.
10. Due to high surface temperatures, keep children, clothing, and furniture away.
11. Risk of Indoor Air Pollution - Use ethanol fireplace only in well-ventilated areas and with doors of adjacent room open. Do not obstruct air flow to the burner by piling logs over the burner, but only around it and do not obstruct the burner in any other way or with any other material. People with breathing problems should consult a physician before using the ethanol fireplace.
12. THIS APPLIANCE HAS NOT BEEN TESTED WITH DOORS OR AN UNVENTED GAS LOG SET. TO REDUCE RISK OF FIRE OR INJURY, DO NOT INSTALL DOORS OR AN UNVENTED GAS LOG SET INTO THIS APPLIANCE.

17, Data Sheet

Model No.	Burner Size	Flame length	Capacity	Fuel Consumption	Heat output	Hole size for fit burner in
18" RC Smart burner	457.2 L x 193mm W x 168mm H	329mm	3 liter	0.5 L~0.6 L/H	2600W ~ 3300W	452.2mm L x 180mm W x 250mm H
24" RC Smart burner	610mm L X 193mm W x 168mm H	482mm	5 liter	0.7~0.8 L/H	2600W ~ 4800W	605mm L x 180mm W x 250mm H
30" RC Smart burner	762mm L x 193mm W x 168mm H	634mm	7.5 liter	0.6~1 L/H	2600W ~ 6000W	757mm L x 180mm W x 250mm H
38" RC Smart burner	908mm L x 193mm W x 168mm H	780mm	8.5 liter	0.9~1.4 L/H	3300W ~ 8000W	903mm L x 180mm W x 250mm H
48" RC Smart burner	1220mm x 193mm W x 168mm H	1092mm	12.5 liter	1.4~2 L/H	4000W ~ 10600W	1215mm L x 180mm W x 250mm H
60" RC Smart burner	1524mm L x 193mm W x 168mm H	1396mm	16 liter	1.8~2.7 L/H	5300W~12000W	1519mm L x 180mm W x 250mm H
72" RC Smart burner	1829mm L x 193mm W x 168mm H	1701mm	20 liter	1.9~3.2 L/H	5300W~15000W	1824mm L x 180mm W x 250mm H
84" RC Smart burner	2133.8mm L x 193mm W x 168mm H	2005.8mm	22.5 liter	2.1~3.6 L/H	5300W~16000W	2123.8mm L x 180mm W x 250mm H

18. Troubleshooting Guide

Warning Symbol	Cause	Solution
Arrow button flashing along with single beeps: B,B,B,B,B,B,B,B,B,B,	CO2 concentration reaches the warning level	Keep the room ventilated as soon as possible
Arrow button flashing along with repetitive two short beeps: BB,BB,BB,BB,BB,BB,	Overheating burning chamber	Leave the burner shut off and wait until the unit cools down
Arrow button flashing along with repetitive three short beeps: BBB,BBB,BBB,BBB,BBB	Overheating fuel tank	Leave the burner shut off and wait until the unit cools down
Arrow button flashing along with repetitive four short beeps: BBBB,BBBB,BBBB,BBBB,	Burner is not level	Make adjustment to the burner level and restart unit
Arrow button flashing along with one short beep and one long beep: BB~~,BB~~,BB~~,BB~~,	Fuel shortage	Shut down the unit, wait until cool and refill more fuel
Arrow button flashing along with two short beeps and one long beep: BBB~~,BBB~~,BBB~~,BBB~~	CO2 warning	Keep the room ventilated and then restart the unit if necessary
Arrow button flashing along with three short beeps and one long beep: BBBB~~, BBBB~~	ignition failed or fire extinguished. Burner will stop working within 30 seconds.	Restart the burner after it cool down
Arrow button flashing along with four short beeps and one long beep: BBBBB~~, BBBBB~~	(When filling manually only) Fuel tank reached maximum capacity; the pump will stop automatically	Stop filling manually

19, Warranty

1. Our fireplaces are guaranteed 5 years, parts and labor. Warranty begins on the date of purchase.
2. Warranty will be applied on presentation of a dated cash receipt and is strictly limited to factory service repair of the piece or pieces that are found to be defective.
3. Installations costs will not be reimbursed in any case as damages for any reason whatsoever.
4. Manufacturer will not be held responsible for any incidental or consequential defects, on goods or individuals.
5. The warranty will not be applied if devices have been subjected to abnormal use or if used under other conditions of use than the ones they were intended for.
6. The warranty will not apply in case of deterioration or accident due to negligence, damages caused by failing to maintain and service the device or resulting from an alteration of material.

Fill out all the fields of below form, email it back to us.

Warranty Claim Form

*Please fill out all the fields

Name _____

Address: _____

Purchased from: _____ Order Number: _____

Model Name / Number: _____ Date of Purchase: _____

Description of Your Claim: _____
